



19, College Walk, Kidderminster, DY10 1PL

Offers In The Region Of £90,000

- 40% SHARED OWNERSHIP
- AN EXCELLENT OPPORTUNITY TO GET ONTO THE PROPERTY LADDER
- PURCHASERS CAN STAIRCASE UP TO 100% FREEHOLD OWNERSHIP
 - SEMI DETACHED HOUSE
 - THREE BEDROOMS & FIRST FLOOR BATHROOM
 - KITCHEN DINER, LOUNGE & DOWNSTAIRS W.C
 - REAR/SIDE GARDENS
- TWO ALLOCATED PARKING SPACES
 - NO UPWARD CHAIN

All Buildings Great & Small



RICS
Regulated by RICS

arla naea
propertymark



intertek
ISO 9001:2015



OnTheMarket

rightmove



40% SHARED OWNERSHIP An opportunity to acquire a three bedroom semi detached house on a shared ownership basis. The property benefits from a large rear/side garden and two allocated parking spaces. NO UPWARD CHAIN

Accommodation comprising reception hall, lounge, kitchen diner, lobby, downstairs WC, landing, three bedrooms, bathroom, store, double glazing to windows as detailed, gas boiler serving radiators. Rear/side gardens. NO UPWARD CHAIN

RECEPTION HALL (inner)

Obscure double glazed front door, panel radiator, staircase with handrail leading to first floor accommodation, door opening onto

LOUNGE (front) 3.60m (max) x 4.58m

Double glazed window to front, panel radiator, door opening onto

KITCHEN DINER (rear) 3.20m plus recess x 4.12m

Double glazed window, panel radiator, wall mounted "Ideal" gas boiler, tiled floor finish, base units with cupboards and drawers, worktops, single bowl single drainer stainless steel sink with mixer tap, plumbing for washing machine and dishwasher, space for cooker, wall mounted store cupboards at high level, door opening onto

REAR LOBBY (inner)

Tiled floor finish, obscure double glazed door onto rear garden, panel radiator, door opening onto

DOWNSTAIRS WC (inner)

WC with push button flush, wash hand basin with tiled splashback, panel radiator, tiled floor.

Staircase from reception hall leading to

FIRST FLOOR LANDING (inner)

Panel radiator, store cupboard over stairs, access to roof space.

BEDROOM ONE (rear) 2.56m x 4.51m

Double glazed window, panel radiator,

BEDROOM TWO (front) 4.27m x 2.55m

Double glazed window, panel radiator,

BEDROOM THREE (rear) 3.46m x 2.15m

Double glazed window, panel radiator,

BATHROOM (front) 2.14m x 1.86m

Obscure double glazed window, panel radiator, WC with push button flush, bath with shower attachment, shower curtain rail, tiling to bath, pedestal wash hand basin, walls tiled to half wall height, extractor,

REAR GARDEN

The property benefits from a good sized garden

COUNCIL TAX BAND C (Wyre Forest)

REVISION 1 GTS 31/10/25

TENURE

The property is currently leasehold. 40% is owned by the vendors with the remaining share owned by Platform Housing Group Ltd. A rent of £391.07 per calendar month. The property can be purchased as a 40% leasehold share (£90,000) up to 100% freehold (£225,000). If the purchaser wishes to buy a share larger than the current percentage, staircasing will take place simultaneously. The cost of any additional shares will be based on a RICS valuation.

All repair and maintenance are the responsibility of the shared owner, there is currently no ground rent collected.

SERVICE CHARGE - A service charge of £83.92 is payable. We are advised the building insurance is covered in the monthly service charge.

SERVICES

The Agents have not tested any apparatus, equipment, fixtures, fittings or services and so cannot verify they are in working order or fit for their purpose. The buyer is advised to obtain verification from their Solicitor or Surveyor.

FIXTURES AND FITTINGS

All items unless specifically referred to in these sales particulars are expressly excluded from the proposed sale. However, fitted carpets, curtains and certain other items may be taken at a valuation to be agreed.

Money Laundering Regulations –

In order to comply with Money Laundering Regulations, all prospective purchasers are required to provide the following - 1. Satisfactory photographic identification. 2. Proof of address/residency. 3. Verification of the source of purchase funds including bank statements for deposits in order to purchase and copy of mortgage agreement in principle from the appropriate lender. In the absence of being able to provide appropriate physical copies of the above, Scriven & Co reserves the right to obtain electronic verification of identity.

Extra services -

By law, the agent must tell the client if the agent or any connected person intends to earn any commission or any other fees from offering or referring other services to the client or buyer. If the agent or any connected person earns money from any of these services or referrals the agent or the connected person would keep this commission or fee. Part of the payment for these extra services will be paid to the agent as a result of the referral.

Scriven & Co offers the following services and has the following referral arrangements in place:

Scriven & Co routinely refers sellers (and buyers) to Infinity Financial Advice. It is the clients' or buyers' decision whether to choose to deal with Infinity Financial Advice. Should the client or a buyer decide to use Infinity Financial Advice the client or buyer should know that Scriven & Co receive a payment from Infinity Financial Advice equating on average to a figure in the order of £200 per referral. Scriven & Co routinely refers sellers (and buyers) to certain firms of solicitors/conveyancers. It is the clients' or buyers' decision whether to choose to deal with any of the referral companies. Should the client or a buyer decide to use any of these companies the client or buyer should know that Scriven & Co receive a payment from these

companies equating to a figure in the order of £100-£200 per referral. We are informed that the solicitors/conveyancers are happy to pay this referral fee to ourselves as it significantly reduces the marketing costs that they have to allocate to sourcing new business. The referral fee is NOT added to the conveyancing charges that would ordinarily be quoted.

The agent routinely refers sellers (and buyers) to a Removals and Storage Company. It is the clients' or buyers' decision whether to choose to deal with the Removals and Storage Company. Should the client or a buyer decide to use the Removals and Storage Company the client or a buyer should know that the agent receives a referral fee to the value of £70 plus VAT from them for recommending a client or buyer to them.

Useful links for property information:

Find information about a property in England or Wales:
<https://search-property-information.service.gov.uk>

Mobile and broadband checker: If mobile coverage and broadband speed is an important issue we would suggest checking with: <https://checker.ofcom.org.uk>

Flooding: If you wish to check flooding information in respect of the property, the following may be of assistance: <https://www.gov.uk/request-flooding-history>

Long term flood risk check of an area in England:
<https://www.gov.uk/check-long-term-flood-risk>

Service provider information: we would suggest the following:

Gas supply:
<https://www.ofgem.gov.uk/information-consumers/energy-advice-households/finding-your-energy-supplier-or-network-operator>
<https://www.findmysupplier.energy>

Electric supply:
<https://www.energynetworks.org/customers/find-my-network-operator>
<https://www.nationalgrid.co.uk>

Water supplier:
<https://www.ofwat.gov.uk/households/your-water-company>
<https://www.water.org.uk/customers/find-your-supplier>

Consumer code for house builders:
<https://consumercode.co.uk>

VIEWING

By appointment with Scriven & Co. Residential Sales Department on 0121-422-4011 (option 1).

Important notices

The Consumer Protection from Unfair Trading Regulations 2008 and the Business Protection from Misleading Marketing Regulations 2008 : Nothing concerning the type of construction or the condition of the structure is to be implied from the photograph (or artists impression) of the property. Items shown in photographs are NOT included unless specifically mentioned within the sales particulars. Certain items may however be available by separate negotiation. The measurements supplied are for general guidance, and as such must be considered as incorrect. A buyer is advised to re-check the measurements themselves before committing themselves to any expense. The Agent has not tested any apparatus, equipment, fixtures, fittings or services, and so does not verify they are in working order, fit for their purpose, or within ownership of the sellers, therefore the buyer must assume the information given is incorrect. Neither has the Agent checked the legal documentation to verify legal status of the property or validity of any guarantee. A buyer must assume the information is incorrect, until it has been verified by their own solicitors. The sales particulars may change in the course of time, and any interested party is advised to make final inspection of the property prior to exchange of contracts. A buyer must check the availability of any property and make an appointment to view before embarking on any journey to see a property. References to the Tenure of a Property are based on information supplied by the Seller. The Agent has not had sight of the title documents. A Buyer is advised to obtain verification from their Solicitor. Any reference to alterations to, or use of any part of the property, is not a statement that any necessary planning, building regulation or other consent has been obtained. A buyer must assume the information is incorrect until it has been verified by their own solicitors.

VAT : All figures quoted are exclusive of VAT where applicable. **Rating Assessments** : Where provided the Agent has made a verbal enquiry with the Local Authority and this information should be verified by interested parties making their own enquiries.

Misrepresentation Act 1967 : These details are prepared as a general guide only, and should not be relied upon as a basis to enter into a legal contract, or to commit expenditure. An interested party should consult their own surveyor, solicitor or other professionals before committing themselves to any expenditure or other legal commitments. If any interested party wishes to rely upon any information from the Agent, then a request should be made and specific written confirmation can be provided. The Agent will not be responsible for any verbal statement made by any member of staff, as only a specific written confirmation should be relied upon. The Agent will not be responsible for any loss other than when specific written confirmation has been requested. (REV02:10/13).









Ground Floor

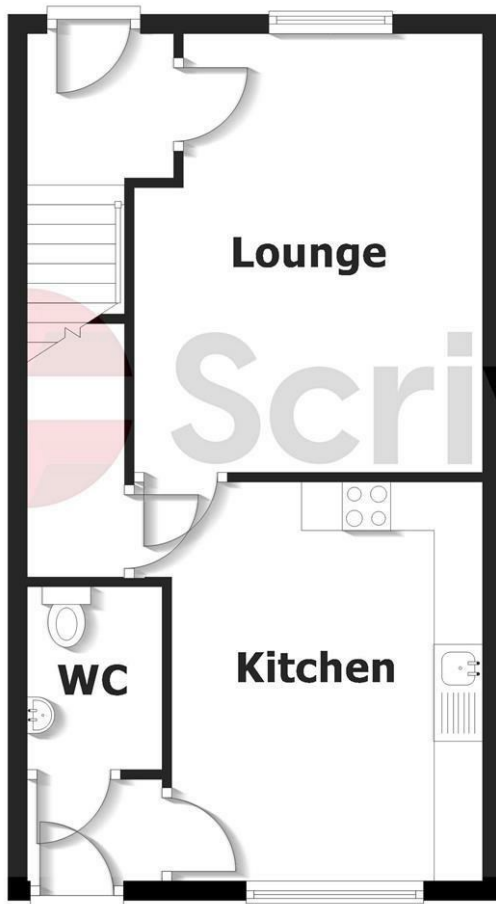

First Floor

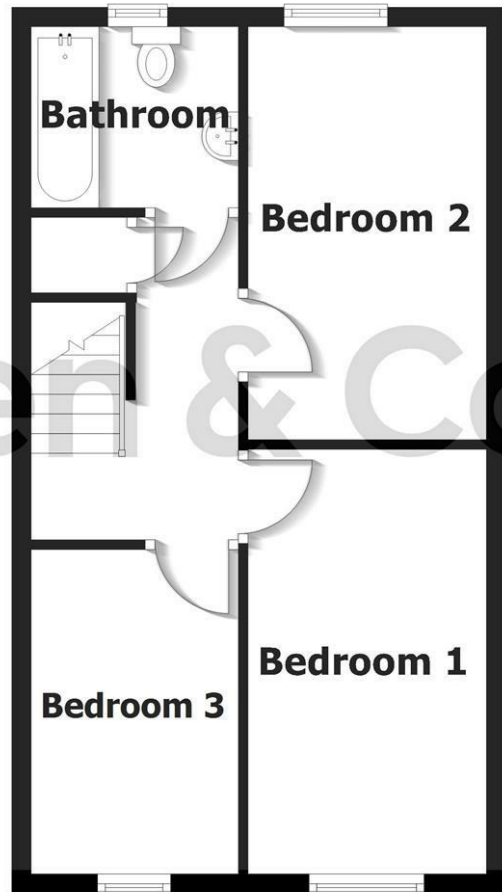

- Estate House, 821 Hagley Road West, Quinton, Birmingham, B32 1AD
- Tel: 0121 422 4011
- E-mail: quinton@scriven.co.uk
- www.scriven.co.uk
- Regulated By RICS

Energy Efficiency Rating		
	Current	Potential
Very energy efficient - lower running costs		
(92 plus) A		
(81-91) B		
(69-80) C	77	82
(55-68) D		
(39-54) E		
(21-38) F		
(1-20) G		
Not energy efficient - higher running costs		
England & Wales	EU Directive 2002/91/EC 